

The World Discusses and  
Asia Influences. Fukuoka  
Opens the Future of MICE.



FUKUOKA CONVENTION CENTER

2-1 Sekijo-machi, Hakata-ku, Fukuoka city 810-0032  
TEL.+81(0)92-262-3898 FAX.+81(0)92-262-4701



<https://www.marinemesse.or.jp/eng>

Printed on Nov 2024



FUKUOKA  
CONVENTION  
CENTER

ENGLISH



FUKUOKA CONVENTION CENTER

# Fukuoka International Congress Center

The Fukuoka International Congress Center boasts state-of-the-art equipment and versatility. With adjustable-sized conference rooms, simultaneous interpreter booths as well as cutting-edge video technology, the facility is available for a variety of conferences, both large and small.



Wi-Fi is available in all areas of the building



2F

## Multipurpose Hall

1F

## Entrance Facility

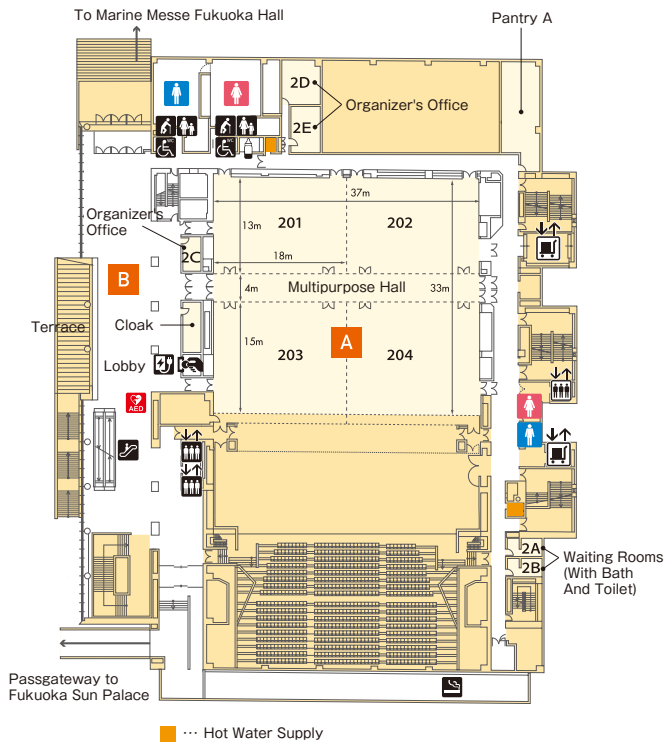
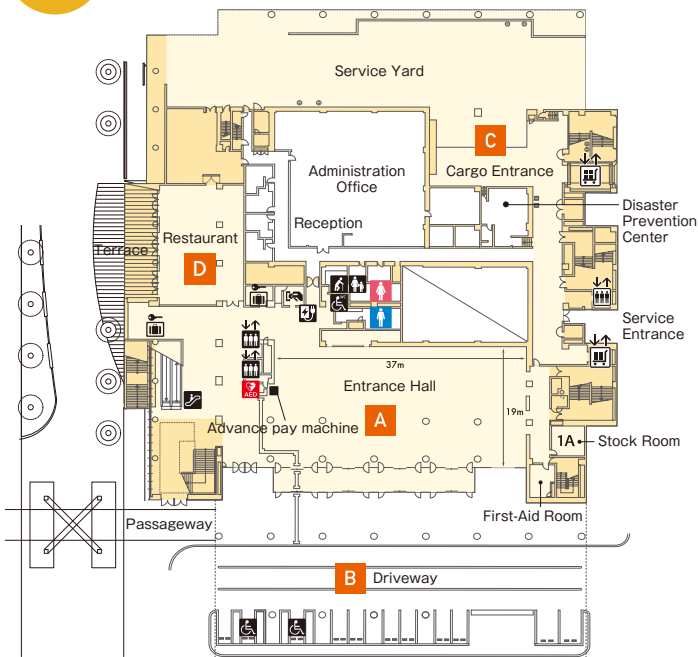

A

Entrance Hall



B

Driveway



C

Cargo Entrance



D

Restaurant



A

Multipurpose Hall



A



B

Lobby



B

3F

## Main Hall

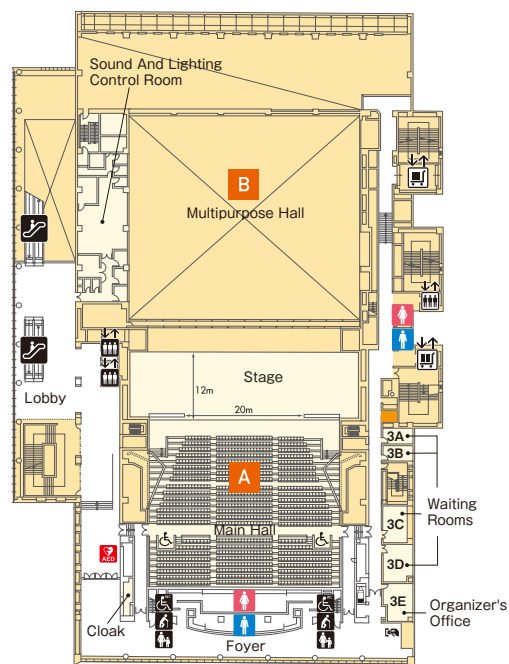

A



A

--- Hot Water Supply

### Main Hall



A + B



A + B

### Convention Hall with a capacity of 3,000

Main Hall and Multipurpose hall on the 2nd floor can be transformed to one room, which accommodates 3,000.

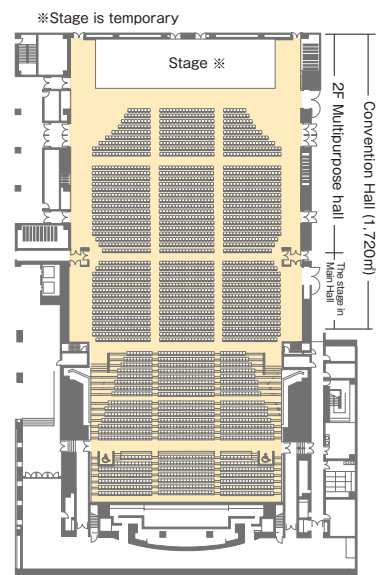

4F

## Conference Rooms (small and medium-sized)

Wi-Fi is available in all areas of the building



--- Hot Water Supply



A  
Conference Rooms  
(Medium-Sized, Single-Room)



B  
Conference Rooms  
(Medium-Sized, 2-Room)



C  
Conference Rooms  
(Small-Sized, Single-Room)



D  
Conference Rooms  
(Small-Sized, 3-Room)



5F

International  
Conference RoomWi-Fi is available in all  
areas of the buildingA  
International  
Conference Room (501)C  
LobbyB  
Conference Rooms  
(Medium-Sized) (502-503)D  
Waiting Rooms (5A-5B)Conference /  
Event Space Outline

\*The figure shown for seating capacity is the maximum possible. Depending on the configuration of your event, the actual seating capacity may be less.  
\*Table size (for 3 persons) W1,800×D600×H700mm

International Conference Room	Area (m <sup>2</sup> )	Ceiling height (m)	Capacity					
			School 3/table	2/table	Theater	Hollow Square	Conference theater	Examination (table 2chairs)
International Conference Room 501	420	5.5	264	176	420	102	420	154
Conference Rooms (medium-sized) 502+503 (single-room layout)	135ea	5.5	75ea	50ea	128ea	54ea	100ea	48ea
502+503 (2-room layout)	270		195	130	304	90	230	104
Conference Rooms (small-sized) 504+505 (single-room layout)	48ea	3.5	27ea	18ea	45ea	24ea	40ea	12ea
504+505 (2-room layout)	96		63	42	110	42	80	28
506	45	3.0	18	12	45	24	—	12
Waiting Rooms 5A	32						8	
5B can be connected	32						10	
PantryC	33						—	
Cloak	18						—	
Conference Room (small and medium-sized)	Area (m <sup>2</sup> )	Ceiling height (m)	Capacity					
			School 3/table	2/table	Theater	Hollow Square	Conference theater	Examination (table 2chairs)
Conference Rooms (small-sized) 401~406 (single-room layout)	75ea	4.2	36ea	24ea	70ea	36ea	50ea	24ea
401+402+403+404+405+406 (2-room layout)	150ea		96ea	64ea	144ea	54ea	108ea	48ea
401+402+403+404+405+406 (3-room layout)	225ea		156ea	104ea	216ea	72ea	192ea	78ea
407	53	3.0	30	20	48	24	—	16
Conference Rooms (medium-sized) 409~414 (single-room layout)	135ea	5.5	75ea	50ea	128ea	54ea	100ea	48ea
409+410+411+412+413+414 (2-room layout)	270ea		195ea	130ea	304ea	90ea	230ea	104ea
Waiting Rooms 4A	17						7	
4B can be connected	17						7	
PantryB	62						—	
Main Hall	Area (m <sup>2</sup> )		Capacity					
Main Hall	—		1,000 fixed seating 6 spaces for wheelchairs					
Main Hall+Multipurpose Hall	1,720		removable seating 2,000					
Waiting Rooms 3A	15						2	
3B	15						2	
3C	34						12 for island style	
3D	33						Japanese-style room	
Organizer's Office 3E	32						12 for island style	
Cloak	12						—	
Multipurpose Hall	Area (m <sup>2</sup> )	Ceiling height (m)	Capacity					
			School 3/table	2/table	Theater	Conference theater	Examination (table 2chairs)	Buffet
(total floor area)	1,320	9.0	882	588	1,536	1,536	528	1,000
201+202 (half floor area:1)	504		330	220	594	500	220	370
203+204 (half floor area:2)	640		396	264	726	580	264	480
201+202 (quarter floor area:1)	252ea		165ea	110ea	270ea	204ea	100ea	180ea
203+204 (quarter floor area:2)	320ea		198ea	132ea	330ea	271ea	120ea	240ea
Waiting Rooms with bathrooms 2A	16						2	
2B	14						2	
2C	15						6 for island style	
2D	39						18 for island style	
2E	30						24 for island style	
PantryA	85						—	
Cloak	21						—	

## Dates for receipt of applications

facility	Day when receipt of application starts	Purpose of use
Any Halls and Conference rooms	As occasion requires	International conference
The whole facility	As occasion requires	Domestic assembly, conference
Multipurpose Hall Main Hall International Conference Room	24 months prior to use	Domestic assembly, conference
Multipurpose Hall Main Hall International Conference Room	12 months prior to use	Other than the above
Multipurpose Hall (partition in in halves/quarters) Small and Medium sized conference rooms	6 months prior to use	

# Four Characteristics for an Infinite Effect. The Ocean's Winds Welcome You to a Multi-complex Convention Zone.



1  
Fukuoka International Congress Center



2  
Marine Messe Fukuoka Hall A



3  
Marine Messe Fukuoka Hall B



4  
Fukuoka Kokusai Center

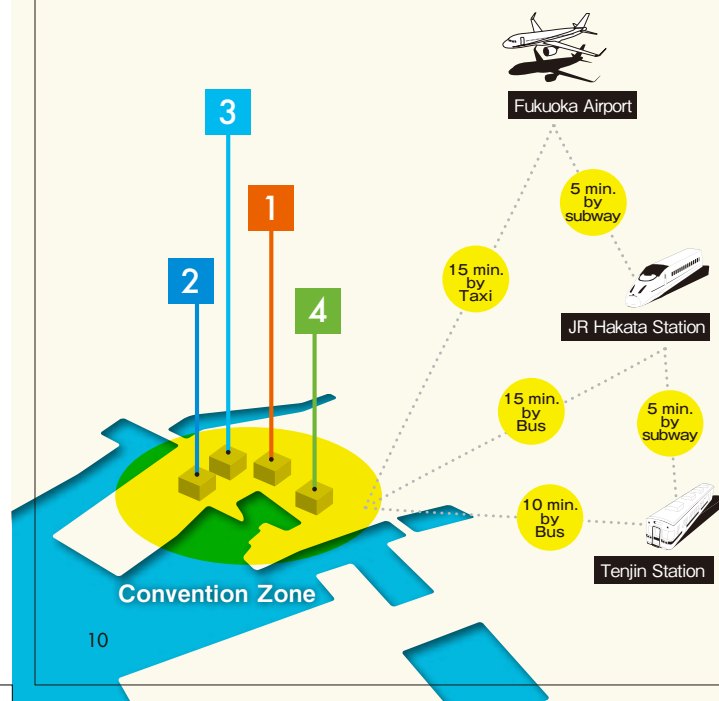

## By Bus or Subway

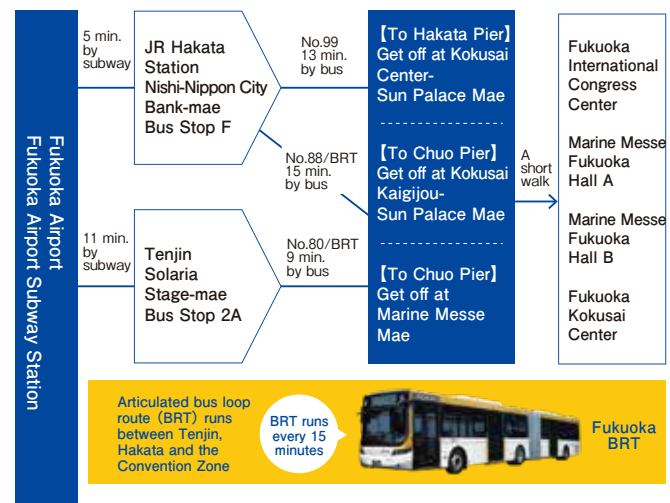

## By car or taxi

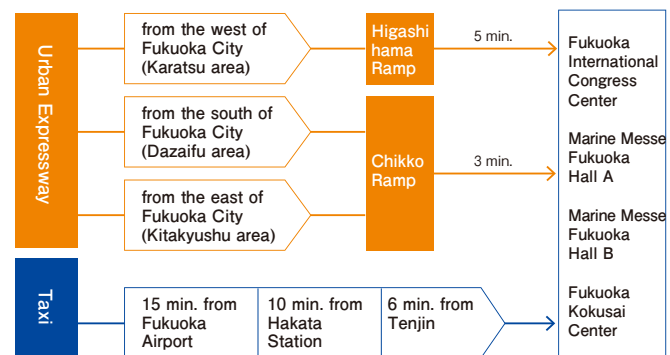

## Access time from major cities in Japan

By Shinkansen Bullet Train	Time	By Airplane	Time	Time
Kumamoto	0:33	Sapporo	2:25	Itami (Osaka) 1:05
Kagoshima	1:20	Sendai	2:00	Matsuyama 0:40
Hiroshima	1:01	Niigata	1:40	Okinawa 1:35
Okayama	1:36	Narita (Tokyo)	1:50	
Shin-Osaka	2:17	Haneda (Tokyo)	1:40	
Nagoya	3:14	Nagoya	1:15	
Tokyo	4:53	Kansai (Osaka)	1:10	

## Access time from major cities in Asia

By Airplane	Time	By Jet Foil	Time
Busan	0:50	Busan	3:40
Seoul	1:15		
Shanghai	1:40		
Beijing	2:30		
Taipei	2:00		
Hong Kong	4:40		
Manila	3:30		
Bangkok	5:00		
Singapore	6:15		

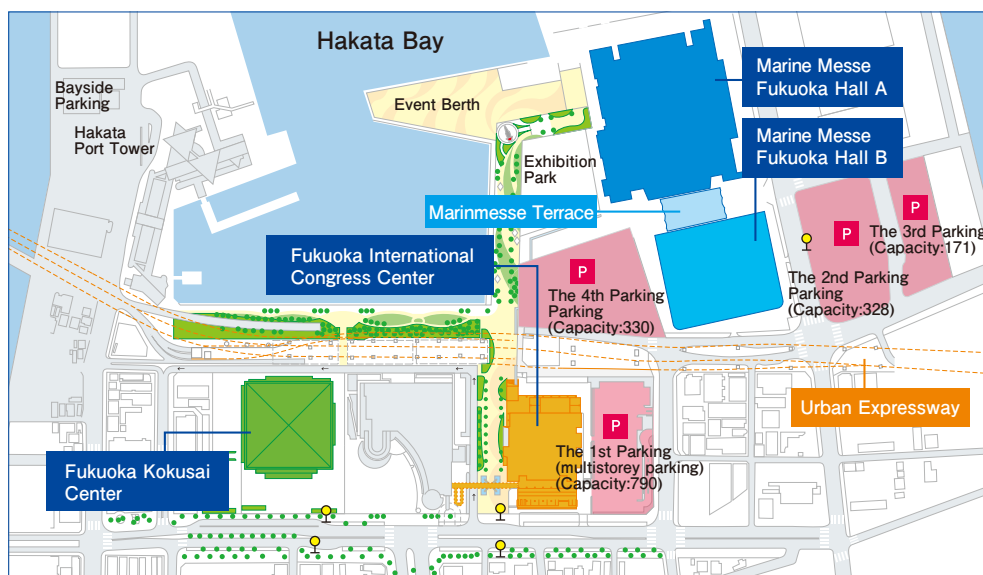

## Marine Messe Terrace

Marine Messe Terrace, with its large roof, will allow for the integrated use of Hall A and B.



※Marine Messe Terrace can be used for exhibition, ceremony, etc.

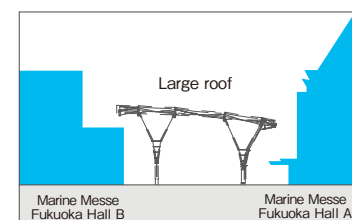

## Principal Features

- Site Area: 3,000m<sup>2</sup> ■ Main Roof Area: 1,200m<sup>2</sup> (25×48m)
- Ceiling Film: Glass cloth titanium dioxide photocatalytic membrane material
- Ceiling Height: 9.5~12m ■ Floor Load: 2t/m<sup>2</sup>
- Pendant Baton: 12m×2, load 100kg/object, remote-controlled
- Equipment: Electrical equipment, Water supply equipment

# FUKUOKA CONVENTION CENTER